

1 - TUB
 1 - 2 SECTION ALLEY
 1 - SQUEEZE CHUTE

25 - 10' PANELS
 8 - 10' WALKTHROUGHS
 1 - W204-10 COMBO
 3 - 3 WAY SPOOLS
 6 - 3 WAY PINS
 36 - FISH HOOKS
 2 - A2 POSTS

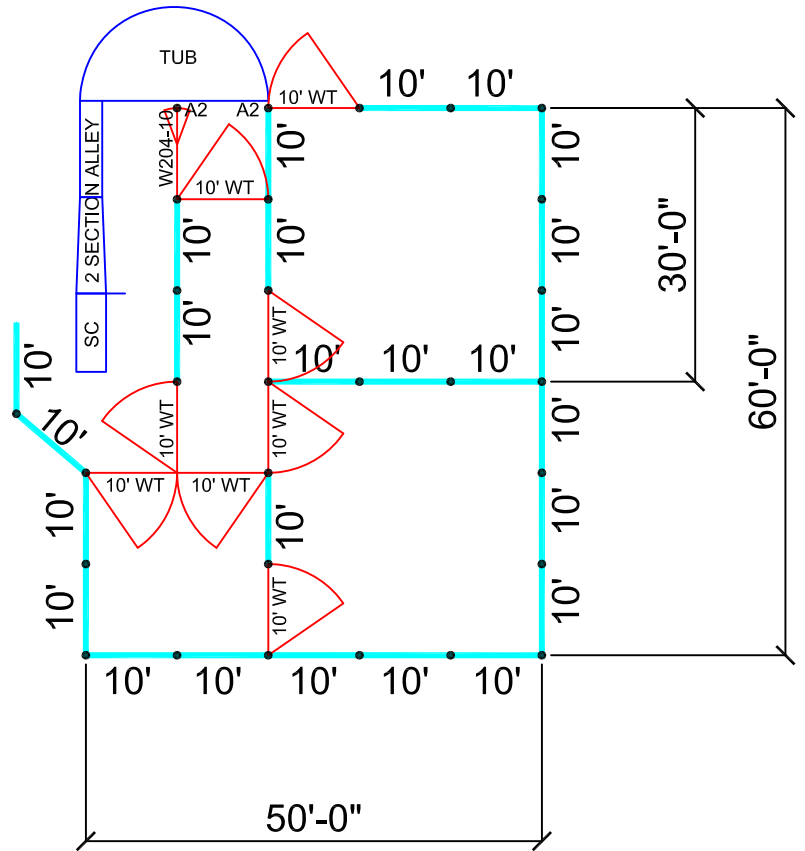

60' x 50' TUB AND ALLEY